

PREVAILING TORQUE SPECS.
1ST ON TORQUE 8 Nm MAX.
1ST OFF TORQUE 1.15 Nm MIN.

PREVAILING TORQUE FEATURE
" 3 HIT SIDE LOCK"

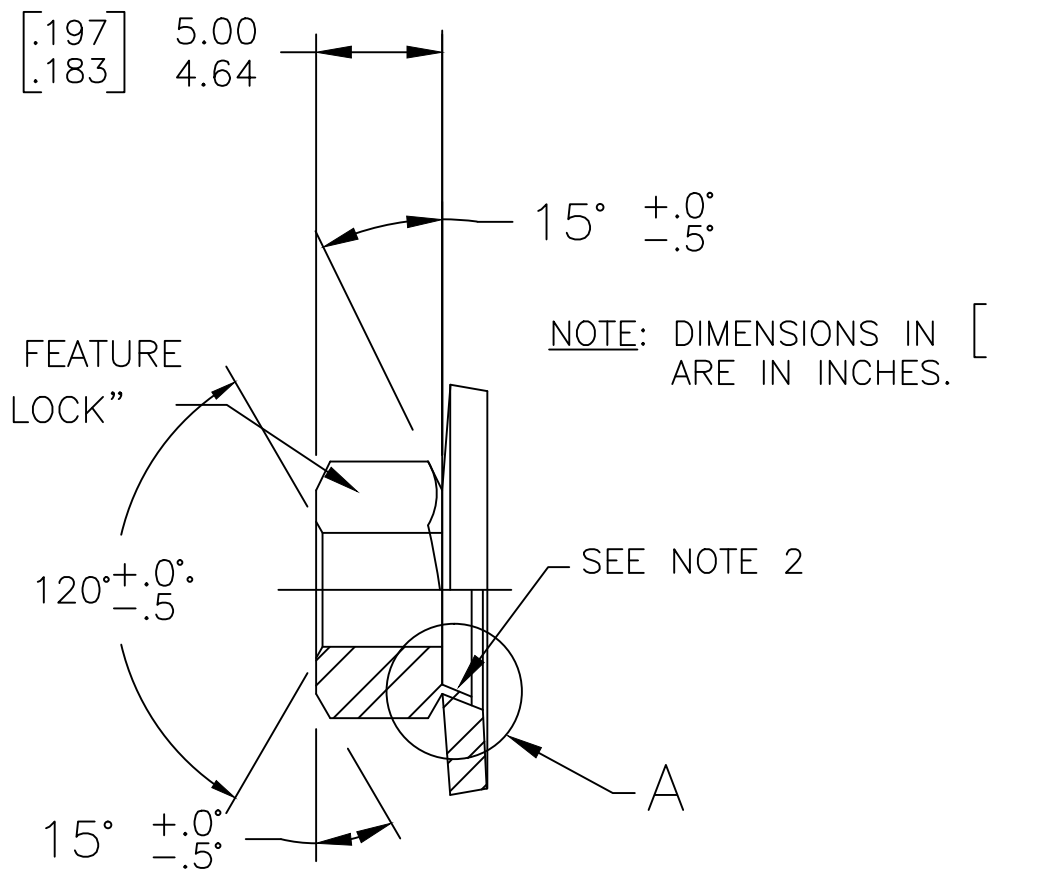

NOTES:

1. A LACK OF FILL AT INTERSECTION OF CHAMFER WITH THE HEXAGON CORNERS SHALL BE PERMISSIBLE.
2. WASHER RETENTION DETAIL SHALL BE OPTIONAL. HOWEVER, NO PORTION OF RETAINING COLLAR SHALL PROTRUDE BEYOND THE WASHER SECTION NOR BE SMALLER THAN THREAD ROOT DIA.
3. WASHER TO BE FIRMLY RETAINED ON NUT. YET BE FREE TO ROTATE AT A TORQUE NOT EXCEEDING 4.0 Nm.
STOCK THICKNESS TO 2.50 - 3.00
CROWN HEIGHT TO 0.00 - 0.30
4. PART MUST BE FREE OF CRACKS, FRACTURES, BURRS AND SHARP EDGES THAT MAY BE DETRIMENTAL TO FIT, FUNCTION AND OR HANDLING.

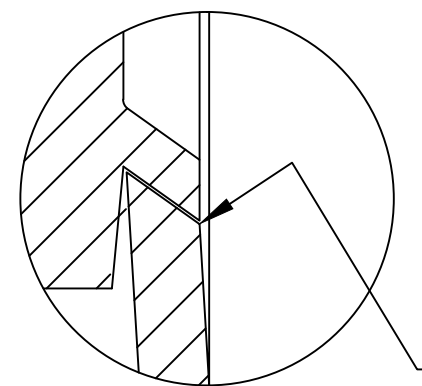

SWAGED EDGE OF COLLAR SHALL NOT PROTRUDE BEYOND FACE OF WASHER.

VIEW OF CIRCLE A

C/N	S	CHANGE	DATE	DR	CH	OK
	A	WAS "DF-9" IDENT	2/27/07	MAK		
	B					
	C					
	D					
	E					



CONFIDENTIAL

THIS DOCUMENT IS THE EXCLUSIVE PROPERTY OF DECKER MANUFACTURING CORPORATION AND IS TO BE RETURNED TO THE COMPANY UPON REQUEST. THE CONTENTS ARE NOT TO BE USED IN ANY MANNER DETRIMENTAL TO THE INTERESTS OF THE COMPANY. THEY ARE NOT TO BE DISCLOSED OR REPRODUCED IN WHOLE OR IN PART WITHOUT EXPRESSED CONSENT.

PART NAME NUT/WASHER ASSEMBLY		
CUSTOMER PART NO.		
MATERIAL NUT SAE 1010 STEEL WASHER SAE 1050 STEEL ROCKWELL C40-48		
FINISH PLAIN		SCALE
DRAWN BY MAK	DATE 2/8/07	PART NO.
CHECKED BY	APPROVED BY	535-3458